

Voltage : 230V/50-60Hz
Power : Sockets max. 16A/3500W

Allersberger Str. 52-54
90596 Schwanstetten

Please read these before commencing installation and retain for Future reference.
If the external flexible cable or cord of this socket is damage, it shall be exclusively replaced by the manufacturer or his service agent or similar qualified person in order to avoid a hazard.

This is a Class I product. Must earth.



If in doubt regarding these installations, consult a qualified electrician.

CAUTION: Risk of Electric Shock - For indoor use only

IP54*

RJ45-DATA SOCKET SPECIFICATION (Optional)

- RJ45 8-connector, category 5 standard
- Contacts are phosphor bronze plated with hard gold.
- Superior performance and low loss signal transmission.
- For cable extension use only, please make sure the extend cable is connected to suitable data socket before use.

Beware of sharp edges!

INSTALLATION

The installation may be carried out by an electrical specialist in accordance with international standards.

- 1** Cut out 92 mm diameter hole in work surface.
Allow minimum 25mm clearance surround the cut hole.
When choosing location, select a surface between 10mm and 50mm thick.
ATTENTION: Ensure there is sufficient space under the installed surface for the unit when it retracts to the closed position.
- 2** The locking ring with rubber washer is supplied in the packaging.
If attached to the mounting collar, remove it by rotating it in an anti-clockwise direction prior to lowering the unit into its final location.
- 3** Insert socket into the hole.
- 4** Place locking ring into collar. Identify and align arrows on properly.
Turn thr locking ring clockwise to tighten. make collar and locking ring to ensure the thread is engaged sure rubber washer is comprsed tightly on underside of surface. Tighten the screw until thr ring firmly grip the surface.
- 5** Connect cable to power supply, once work has been completed correctcly, the product is now ready to use.

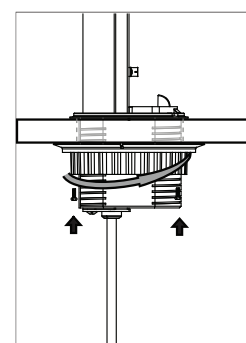
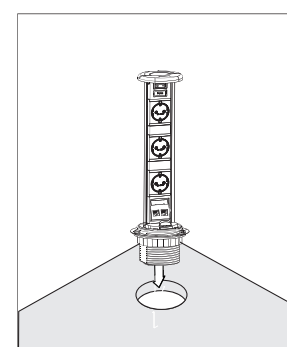
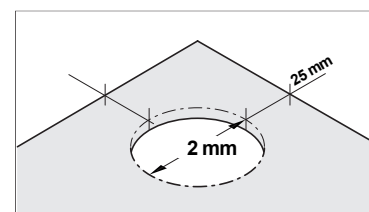

- 1 To use the Pop-up Socket, gentle lift up the silver handle on the top cover until all socket outlets are exposed and the orange stop-/release button clicks and locks unit in place.

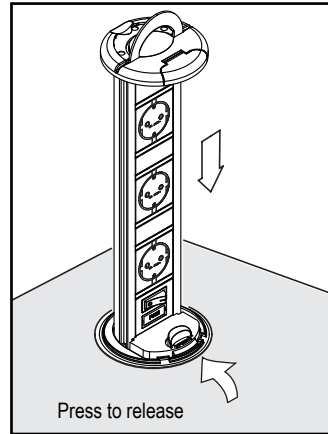
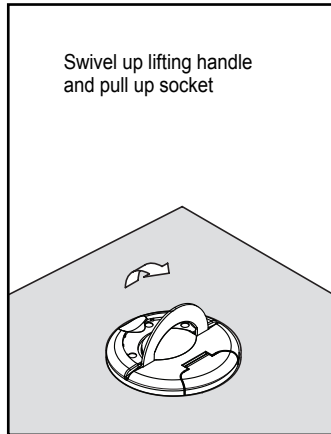

- 2 Press the master switch on. An orange light confirms that power is available. You can use all the power sockets. The unit can be retracted in position by pressing the orange stop-/release button and push the unit down until it is flush with the surface. And leaving the engaged cables on the window of the top cover.

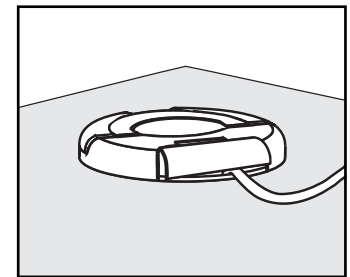

ATTENTION:
Only use the silver handle to lift the unit.

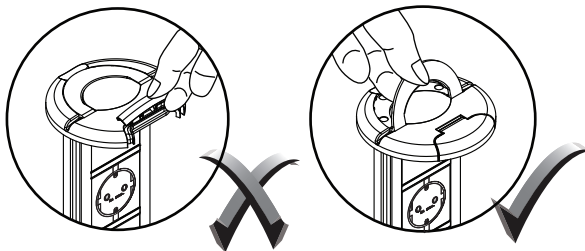

*** ATTENTION:**
IP54 is only available when remove all plugs from socket and in closed position.



IP54

MAINTENANCE

- Ensure that to disconnect the power prior to cleaning.
- To keep the finish of this product, wipe over with soft cloth periodically.
- Clean the socket with a damp cloth and mild detergent, dry immediately.
- Do not use harsh chemical solvents, it may dis-color or damage the finish.
- Never force to life up or push down – always check that there are no obstructions that could interfere during retraction.